

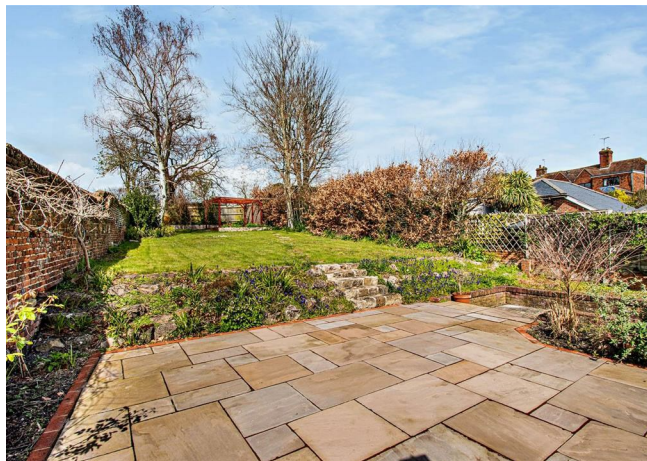

Chaucers Upper Street, Hollingbourne, Maidstone, ME17 1UW
Price £700,000

Chaucers is an impressive 3 bedroom detached period house dating back to 1888 which benefits from a detached garage with workshop above, as well as a 100ft private rear garden with patio and decked seating areas. The ground floor comprises high quality contemporary kitchen with quartz worktops and breakfast area, sitting room with imposing inglenook fireplace and log burner, family room with log burner, study, utility room, and a shower room. Upstairs, there is a principal bedroom with period fireplace and a large en-suite bathroom with separate bath and shower unit, as well as two further bedrooms. Externally, the rear garden is well established with flower and shrub borders and benefits from a recently laid patio area to the front and decked seating area to the rear.

The property is situated adjacent to the original boundary of 16th century Hollingbourne Manor, famously owned by the prominent Culpepper family, and shares the Manor wall on one side of the garden. The popular village of Hollingbourne is served by a general store with coffee shop, a few popular pubs and restaurants, a hairdressers, osteopaths, primary school, parish church and local parks/walks through the countryside. There is a London line station within a few minutes' walk with free parking, travelling direct to Victoria and Blackfriars, and two stops to Maidstone, the county town of Kent, which is approx. 6-miles distance. Council Tax Band: F.



GROUND FLOOR:

- Hall
- Sitting Room
- Family Room
- Study
- Kitchen/Breakfast Room
- Utility Room
- Shower Room

Strictly by arrangement with the Agent's Bearsted Office, 132 Ashford Road, Bearsted, Maidstone, Kent ME14 4LX. Tel: 01622 739574.

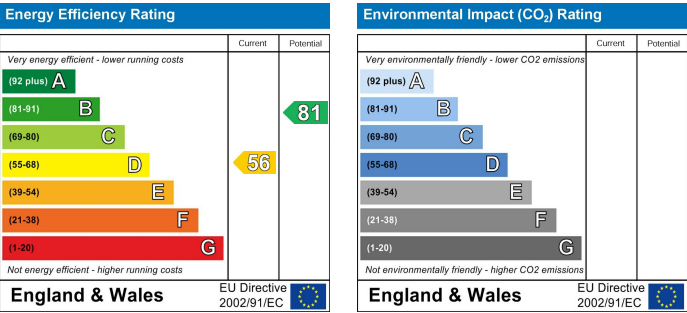

FIRST FLOOR:

- Principal Bedroom
- En-suite Bathroom
- Bedroom 2
- Bedroom 3

EXTERNALLY

- Garage
- Workshop
- Garden
- VIEWING

Page & Wells limited for themselves and for the vendors of this property whose agents they are give notice that: 1. These particulars do not constitute any part of, an offer or a contract. 2. All statements contained in these particulars as to this property are made without responsibility on the part of Page & Wells Limited or the Vendor. 3. None of the statements contained in these particulars as to the property is to be relied on as statements or representations of fact. 4. Any intending purchaser must satisfy himself by inspection or otherwise as to the correctness of each of the statements contained in these particulars. 5. The vendor does not make or give, and neither Page & Wells Limited nor any person in their employment has any authority to make or give any representation whatsoever in relation to this property. These particulars are supplied on the understanding that all negotiations are carried out throughout Page & Wells Limited. Properties with a reference prefixes EAA are those which Page & Wells Limited disclose an interest in accordance with the provisions of the Estates Agents Act 1979



Upper Street, Hollingbourne, Maidstone, Kent
Main House internal area 1,395 sq ft (130 sq m)
Garage & Workshop internal area 258 sq ft (24 sq m)

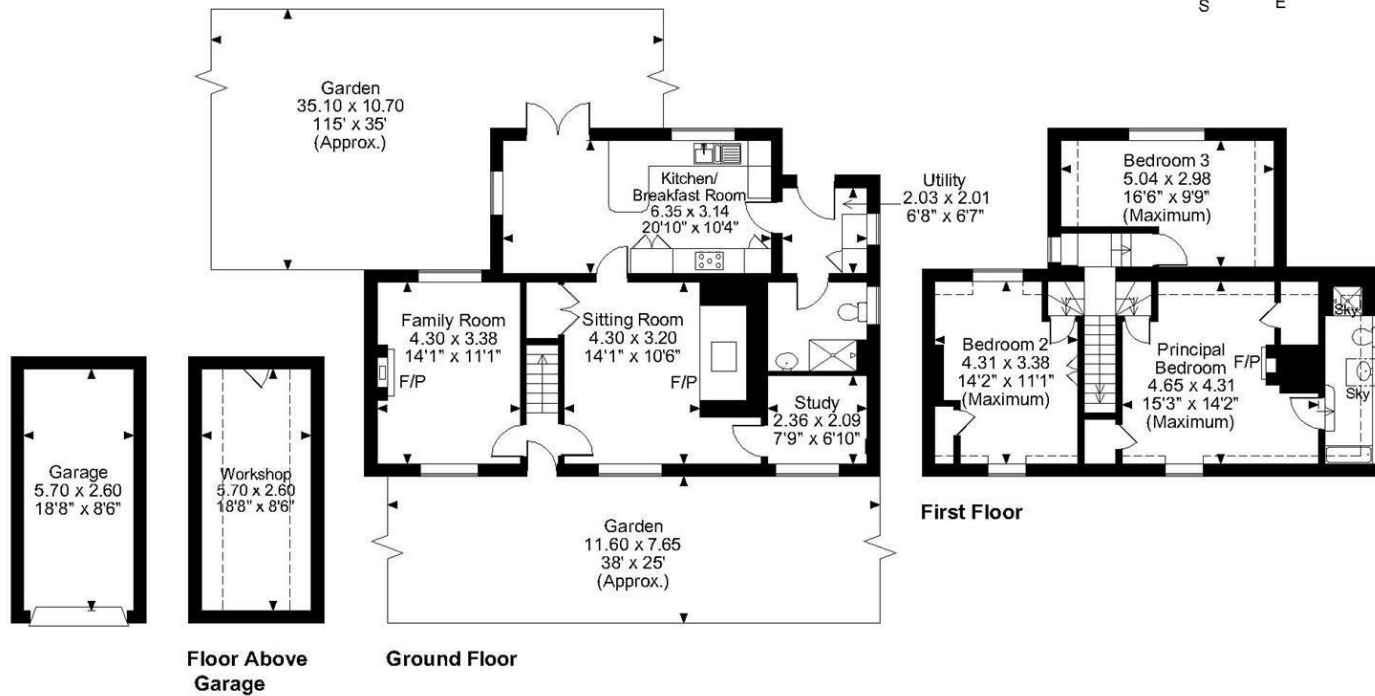
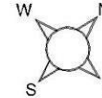

FOR ILLUSTRATIVE PURPOSES ONLY - NOT TO SCALE

The position & size of doors, windows, appliances and other features are approximate only.

□ □ □ Denotes restricted head height

© ehouse. Unauthorised reproduction prohibited. Drawing ref. dig/8547559/TOW

